



1 1/16" BORE STAINLESS STEEL CYLINDER

SRR-17-□-□

Reverse Acting

Mount: Stud **Standard Stroke Lengths:** 1/2", 1", 1-1/2", 2", 3", 4"
Type: Rotating Rod **Spring Compressed:** 7 lbs. **Spring At Rest:** 2 lbs.
Options: MB, B, H, W, V, N For magnetic bumpers add .312

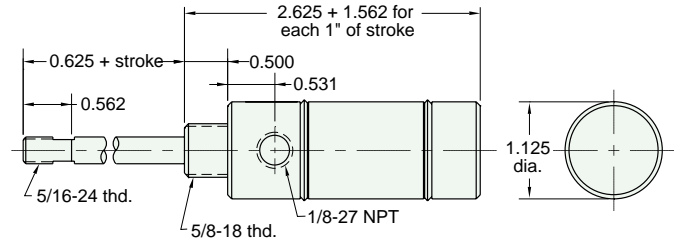

Nuts included, but not shown on drawing

URR-17-□-□

Reverse Acting

Mount: Universal **Standard Stroke Lengths:** 1/2", 1", 1-1/2", 2", 3", 4"
Type: Rotating Rod **Spring Compressed:** 7 lbs. **Spring At Rest:** 2 lbs.
Options: MB, B, H, W, V, P6, N For magnetic bumpers add .312

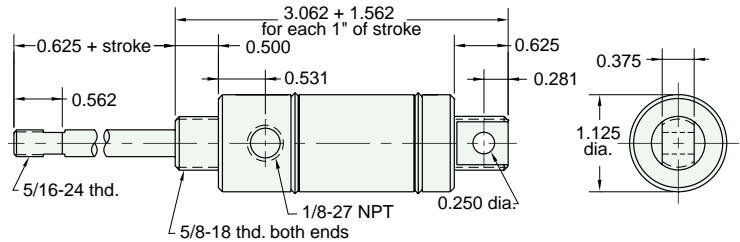
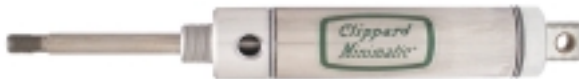

Furnished without nut(s). See Chart on Page 34.

SFD-17-□-□

Spring Bias

Mount: Stud **Standard Stroke Lengths:** 1/2", 1", 1-1/2", 2", 3", 4"
Type: Double Rod **Spring Compressed:** 7 lbs. **Spring At Rest:** 2 lbs.
Options: MB, B, H, W, V, P6, P7, P8, N For magnetic bumpers add .312

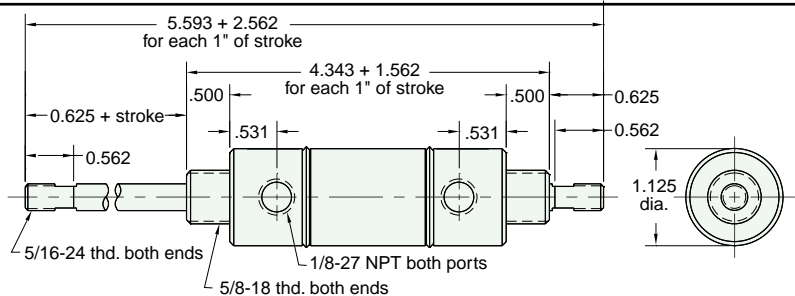
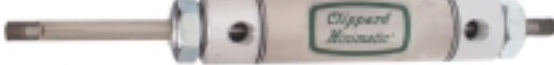

Nuts included, but not shown on drawing

SBR-17-□-□

Double Acting Rear Spring Bias

Mount: Stud **Standard Stroke Lengths:** 1/2", 1", 1-1/2", 2", 3", 4"
Type: Rotating Rod **Spring Compressed:** 7 lbs. **Spring At Rest:** 2 lbs.
Options: MB, B, H, W, V, P6, P7, P8, S, N For magnetic bumpers add .312

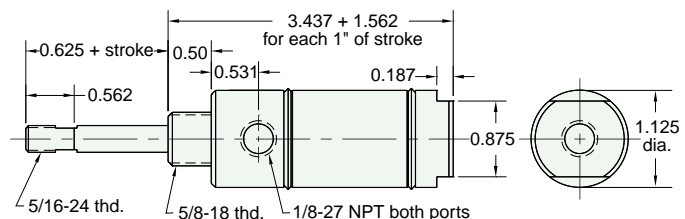

Nut included, but not shown on drawing